

Features:

- 600V volts rating (R.M.S.)
- Thickness: 0.2mm

Specifications:

- Voltage rating: 600V AC, DC
- Current rating up to 9A (with #18 AWG)
- Dielectric withstanding Voltage: 1500V AC/minute
- Contact resistance: Initial value/10mΩ Max.
After environmental testing/20mΩ Max.
- Crimp resistance: 5mΩ Max,
- Terminal retention force: 3.0Kg Mn.
- Ambient temperature range: -40°C ~ 105°C
(including temperature rise)

Ordering & Dimensional Information (mm)

Dimension				Wire Size (AWG)	Material	Finished
a	b	c	d			
2.3	2.3	1.65	1.8	#22 ~ #28	Brass	Tin-plated (Lead free)

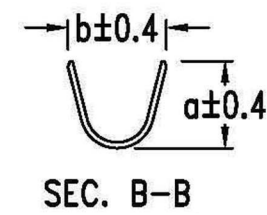
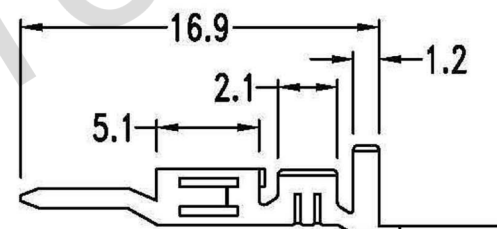
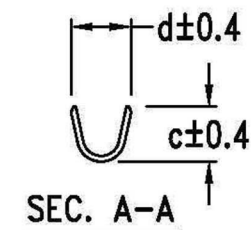
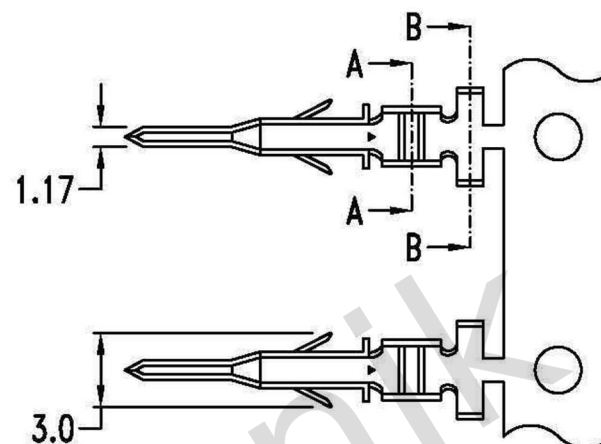

Oznaczenie	JS-1148-TBJ HM		
Opis	4.2mm Male Terminal Brass Material Tin Plating 22~28AWG ROHS Low-lead		
	WWELEKTRONIK ul. Kraszewskiego 26 81-815 Sopot		Tel. 058 551-11-15 fax. 058 550-45-17 e-mail: info@wwelektronik.com.pl
	www.wwelektronik.com.pl		